

# OPERATING & SAFETY GUIDE

## STEAMER

### GENERAL SAFETY

Contact us for information and advice on the suitability and safety of this type of equipment. There is a risk of injury if you do not follow the instructions printed in this guide.

This equipment should only be used by a competent adult who has read and understood these instructions.

Anyone with a temporary or permanent disability should seek expert advice before using the equipment.

Keep all children, animals and bystanders away from the work area. Ensure the floor of the work area is free from trip hazards and non-slip. Never use the equipment if you are ill, tired or under the influence of alcohol or drugs.

Never operate electrical switches with wet hands.

Always switch off and unplug the equipment from the power supply before moving or cleaning. Check the equipment before use, if it shows signs of damage request a replacement.

### ELECTRICAL SAFETY

The equipment is designed to plug directly into a standard 240volt, 13 amp socket. Make sure the equipment and power socket are switched off before plugging into the power supply.

If the equipment fails to operate or the power cable or plug becomes damaged, contact us. Do not try to repair it yourself.

Keep the power cable out of harm's way. Extension leads should be unwound fully, never run them through water, over sharp objects or where they may be a trip hazard.

Use a suitable RCD (Residual Current Operated Device) to reduce the risk of electric shock.

### OPERATING GUIDE

**NOTE: THE steamer is designed to be used with clean tap water, no additives in any form should be used as the use of additives (except Propress Descaler) will damage the equipment.**

**NOTE: Your steamer is fitted with a safety filler cap. In some circumstances steam or water can be released from the filler cap. In the event that this occurs turn off immediately to ensure no damage is caused to the steamer or hose. DO NOT REMOVE THE FILLER CAP. WAIT FOR STEAMER TO COOL DOWN.**

#### Potential causes of this are:

- The steamer has been overfilled
- The steamer needs rinsing out and descaling to remove build up of sediment or limescale
- The steamer hose is blocked, kinked or restricted

### OPERATING GUIDE cont'd

#### Filling Steamer with Water:

Remove the Filler Cap from the steamer.

Measure 2L of hot or cold tap water and pour in using funnel supplied.

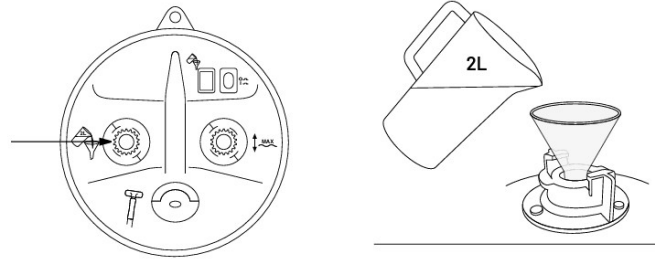

**Do not overfill. When the steamer is full the indicator float will appear in the sight glass.**

#### Switching On:

Plug the steamer into a suitable power outlet and push down the green on/off switch that will illuminate to indicate the steamer is "on" and heating up.

**NOTE:** The water in the steamer will take 10 to 15 minutes to produce steam, dependent upon the water temperature, ambient temperature and also the efficiency of your electrical supply.

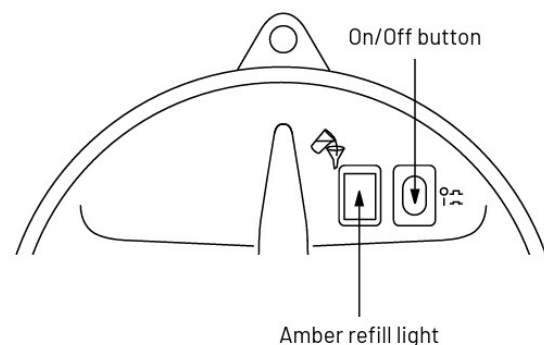

**If the amber "empty/refill" indicator light illuminates and the buzzer sounds when the steamer is switched on, your steamer is empty of water. Turn off the power and refill according to instructions Filling Steamer with Water.**

# OPERATING & SAFETY GUIDE

## STEAMER

### OPERATING GUIDE cont'd

**Using Your Steamer:** Ensure the area you are steaming in is well ventilated.

Once steam is emitting from the nozzle, allow the hose and nozzle to get hot for approximately 30 seconds before using the steamer. This reduces any condensation build-up.

Lift hose handle from the hook, shake/flick nozzle vigorously to remove any excess condensation before use and repeat periodically when steaming garments.



Do not kink or restrict the hose, as this may cause an ejection of water and irreparable damage to hose.

Always return the hose handle to the hook on the pole assembly when not in use.

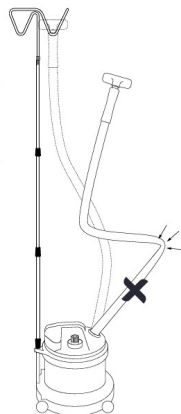

### TIPS ON USE

#### Steaming Clothing:

Garments can either be steamed on a hanger, rail, mannequin or hung from the hook on the pole assembly.

**NOTE: Ensure that the pole hook is over the steamer when hanging garments on it. This maintains the stability of the machine.**

Run nozzle over the fabric while holding it taut with your free hand, taking care not to steam near your hand in the process. Always keep the row of holes on the nozzle horizontal at all times. If steaming at a low level regularly lift hose up so condensation can be allowed to run back into the steamer.

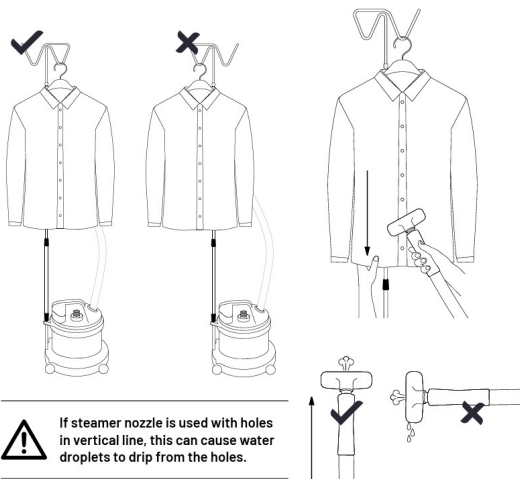

If steamer nozzle is used with holes in vertical line, this can cause water droplets to drip from the holes.

### TIP ON USE cont'd

#### Full Garments:

Full garments, such as dresses and skirts can be steamed from the inside by touching the nozzle on to material and steaming outwards. Caution is required as steam can build up inside the garment and get extremely hot. Steaming from the inside reduces the possibility of adding creases and opens up gathers; bringing dresses back to life.

#### Wedding Dresses:

Wedding dresses should not be hung on the pole set as their weight can make the steamer unstable and topple over. They are best steamed hanging from a rail or, ideally, using a plastic chain attached to a hook in the ceiling. This allows the dress to be hung at different heights on the chain so the lower parts of the dress and the train can be steamed with ease. Steam the dress in sections, starting with the underskirt.

The back of the nozzle can be used as a low temperature iron to confirm creases and to shape collars.

If steaming at a low level, regularly lift hose up so condensation can be allowed to run back into the steamer.



**Never steam clothes whilst they are being worn by a person.**

**Use extreme caution when operating the appliance. Steam can burn.**